

900 N OCEAN BOULEVARD

THE NORTH THREE HUNDRED (300.00) FEET, OF GOVERNMENT LOT 1, SECTION 31, TOWNSHIP 48 SOUTH, RANGE 43 EAST AND THE NORTH THREE HUNDRED (300.00) FEET OF THE N.W. 1/4 (NORTHWEST ONE-QUARTER) OF SECTION 32, TOWNSHIP 48 SOUTH, RANGE 43 EAST, CITY OF POMPANO BEACH, BROWARD COUNTY, FLORIDA

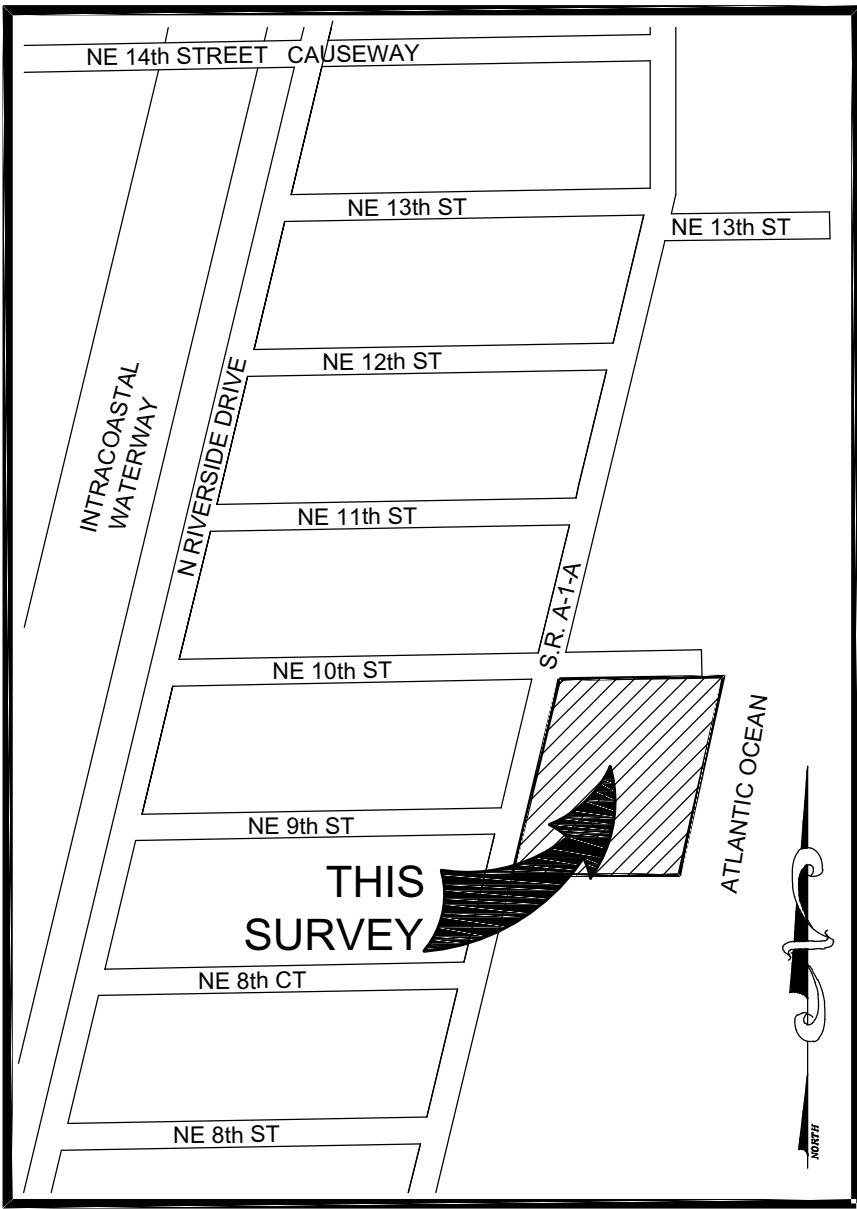

LOCATION SKETCH NOT TO SCALE

DESCRIPTION:

THE NORTH THREE HUNDRED (300.00) FEET OF THE FOLLOWING DESCRIBED PARCEL OF LAND: THAT PART OF THE NORTH 508.00 FEET OF GOVERNMENT LOT 1, SECTION 31, TOWNSHIP 48 SOUTH, RANGE 43 EAST AND THE NORTH 508.00 FEET OF THE NORTHWEST ONE-QUARTER (N.W. 1/4) OF SECTION 32, TOWNSHIP 48 SOUTH, RANGE 43 EAST LYING EAST OF THE CENTERLINE OF STATE ROAD A-1-A, COMMONLY KNOWN AS OCEAN BOULEVARD, AS SAID PARCEL OF LAND BEING BOUNDED ON THE WEST BY THE CENTERLINE OF SAID STATE ROAD A-1-A AND ON THE EAST BY THE ATLANTIC OCEAN, TOGETHER WITH ALL LITTORAL AND RIPARIAN RIGHTS THEREUNTO APPERTAINING.

SAID LANDS LYING AND BEING IN THE CITY OF POMPANO BEACH, BROWARD COUNTY, FLORIDA AND CONTAINING 133,596 SQUARE FEET OR 3.067 ACRES MORE OR LESS.

PREPARED BY:

**KEITH**

1 EAST ATLANTIC BOULEVARD
POMPANO BEACH, FLORIDA 33062-6643
(954) 788-1100
EMAIL: mail@KEITHFL.com FAX: 954-788-1101

XXX-MP-21